

Thank you Don Stice for supplying these plans.

<http://sticefamily.net/Savannah.aspx>

BOOKLET  
OF  
GENERAL PLANS

N. S. SAVANNAH

N. Y. S. CONT. 529

COMPLEMENT

PASSENGERS (ONE CLASS)	50
OFFICERS	23
CREW	34
GOVERNMENT PERSONNEL	3
SPARES	7
TOTAL COMPLEMENT	134

CLASS

A. B. S. + AIE, + AMS.

GENERATING PLANT

TWO (2) DIESEL, 450 H.P., 3 PHASE, 60 CYCLE, .83 POWER FACTOR  
TURBO GENERATOR

STEERING GEAR DATA

RAPSON SLIDE, ELECTRO-HYDRAULIC FOUR CYLINDER TYPE.  
THE DESIGN PRESSURE FOR THE HYDRAULIC SYSTEM SHALL NOT  
EXCEED 2000 PSIG.

REFRIGERATING PLANT

DIRECT EXPANSION OF FREON-12 TYPE SUPPLIES: SHIP'S  
REFRIGERATED STORES SPACES, SERVICE BOXES, DOLE PLATE,  
ICE BINS, MIXING STATION, ETC.

DECK MACHINERY DATA

FOUR (4) ELECTRIC BOAT WINCHES  
ONE (1) HYDRAULIC DRIVEN HORIZONTAL SPUR GEARED WINDLASS  
TWELVE (12) ELECTRO-HYDRAULIC CARGO WINCHES  
TWELVE (12) TOPPING & TWELVE (12) YANG WINCHES  
TWO (2) ELECTRIC DRUM TYPE WINCHES FOR ACCOMMODATION LADDERS

EQUIPMENT (A.B.S. NUMERAL)

A.B.S. RULES FOR EQUIPMENT NUMERAL C-46(9)

LIFE BOAT & DAVIT DATA

ONE (1) 23'-0" HAND-PROPELLED 50 PERSONS  
ONE (1) 23'-0" MOTOR-PROPELLED 50 PERSONS  
TWO (2) 26'-0" OAR-PROPELLED 40 PERSONS  
STEEL GRAVITY LIFEBOAT DAVITS

GENERAL CHARACTERISTICS

LENGTH OVERALL (APPROX.)	595'-5"
LENGTH B.P.	545'-0"
LENGTH FOR SCANTLINGS	539'-0"
LENGTH, EFFECTIVE FORM	535'-0"
BEAM, MOLDED	78'-0"
DEPTH TO PROMENADE DECK	58'-3"
DEPTH TO A DECK AMIDSHIPS	50'-0"
DEPTH TO B DECK AMIDSHIPS	41'-0"
DRAFT, DESIGN	29'-6"
DRAFT, SCANTLING	31'-6"
DRAFT, LIGHT (APPROX.)	18'-6"

DEADWEIGHT, DISPLACEMENT AND LIGHT SHIP

TOTAL DEADWEIGHT, TONS (APPROX.)	9,990
FULL LOAD DISPLACEMENT, TONS	21,840
LIGHT SHIP, TONS (APPROX.)	11,850

HOLD AND TANK CAPACITIES

CARGO HOLD 746,200 CUBIC FEET - BALE

POWER PLANT AND SPEED

NUCLEAR PRESSURIZED-WATER REACTOR-GEARED STEAM  
TURBINE MAXIMUM CONTINUOUS SHAFT HORSEPOWER 31,000

PROPELLER

NUMBER OF BLADES	5
DIAMETER IN FEET	22'-0"
WEIGHT, ESTIMATED, LBS. (APPROX.)	65,000





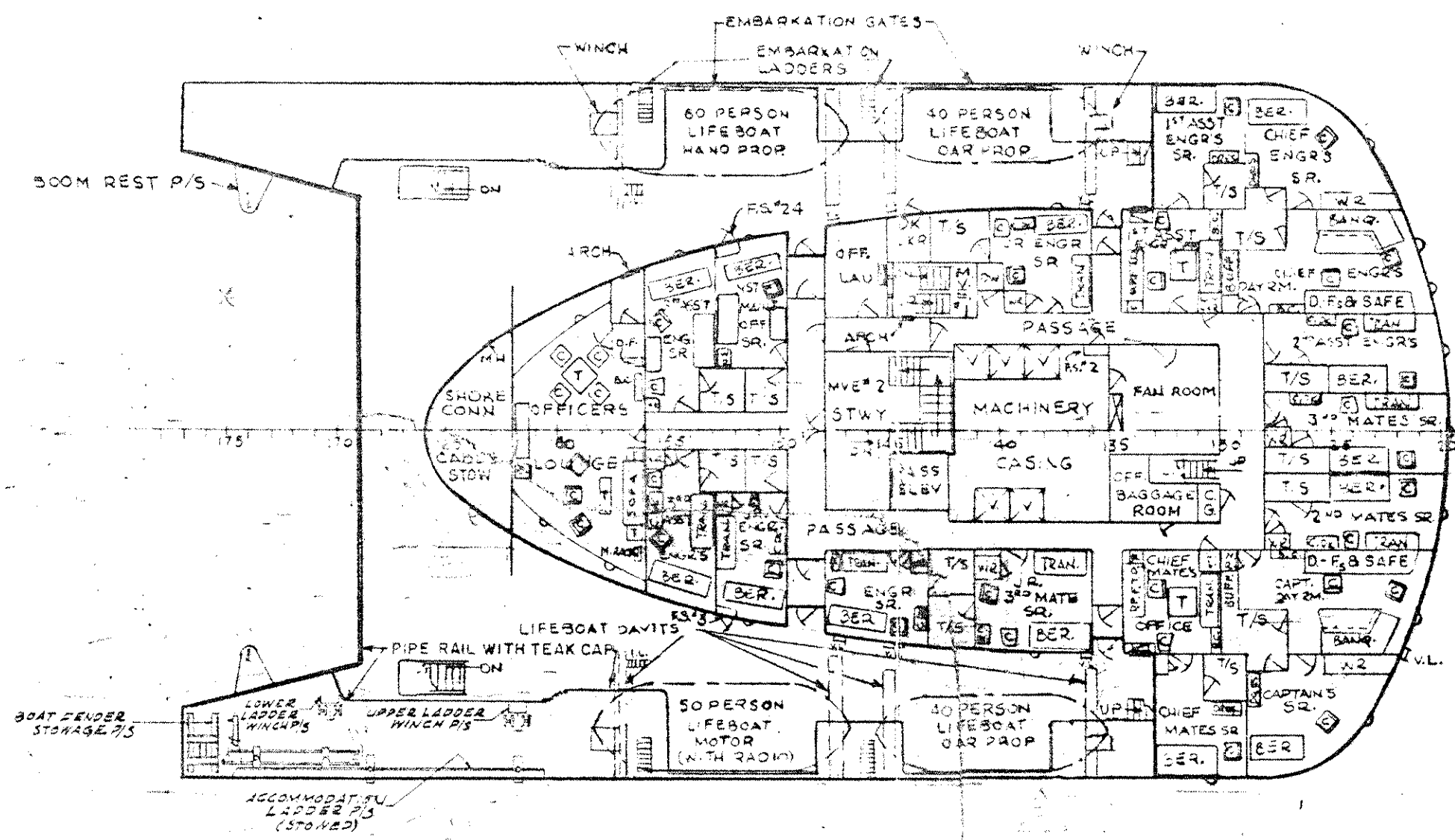

BOAT DECK

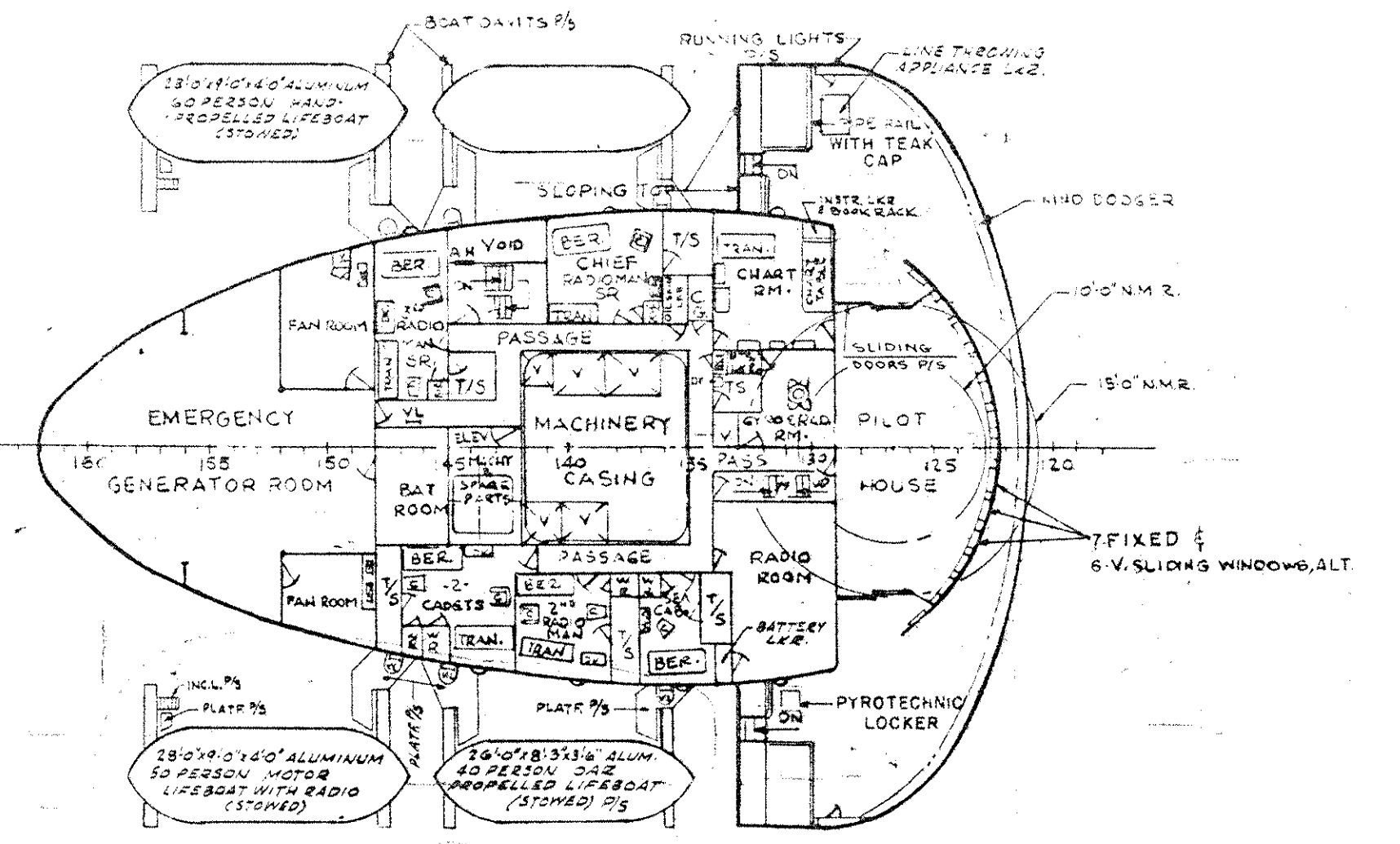

NAVIGATION BRIDGE DECK

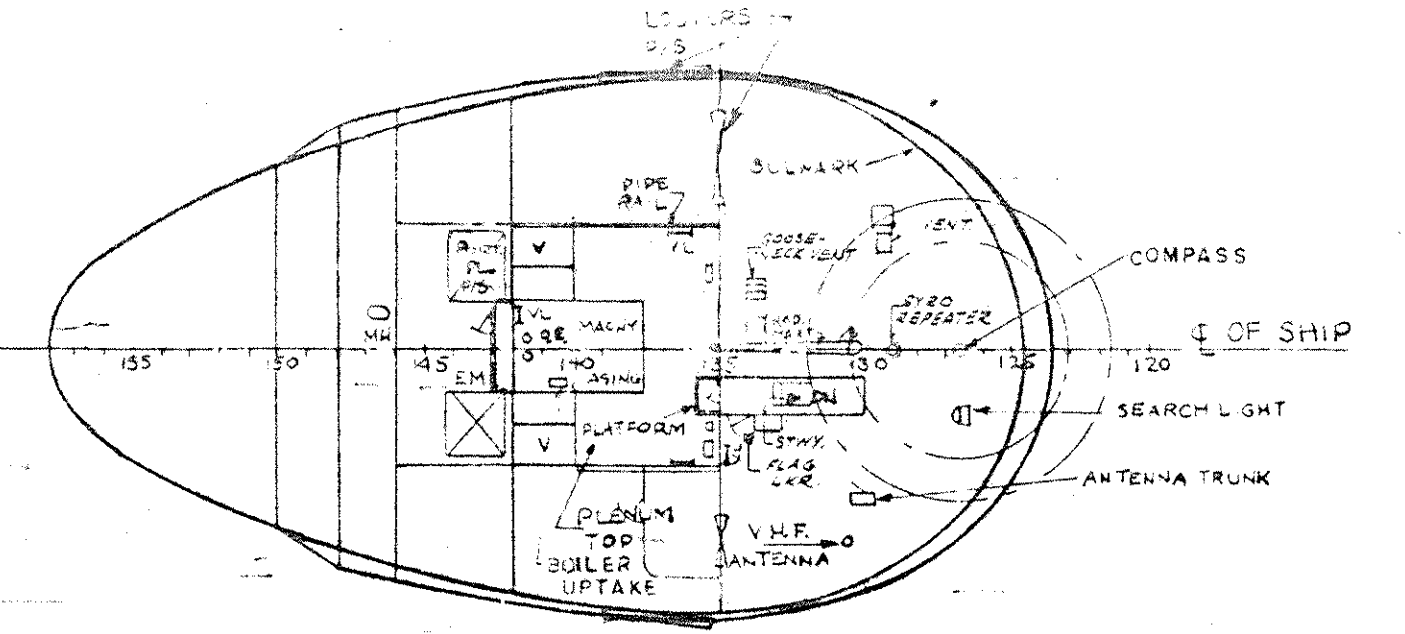

TOP OF HOUSE

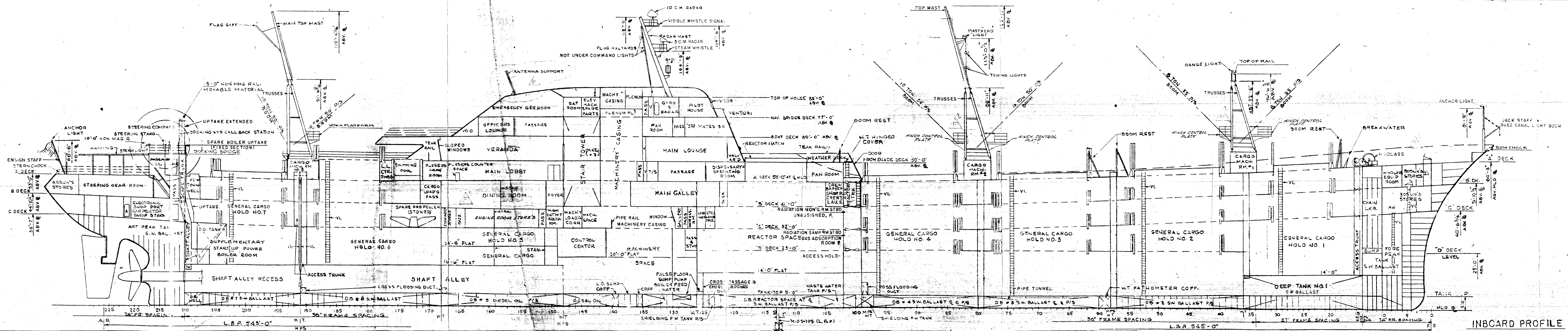

INBOARD PROFILE

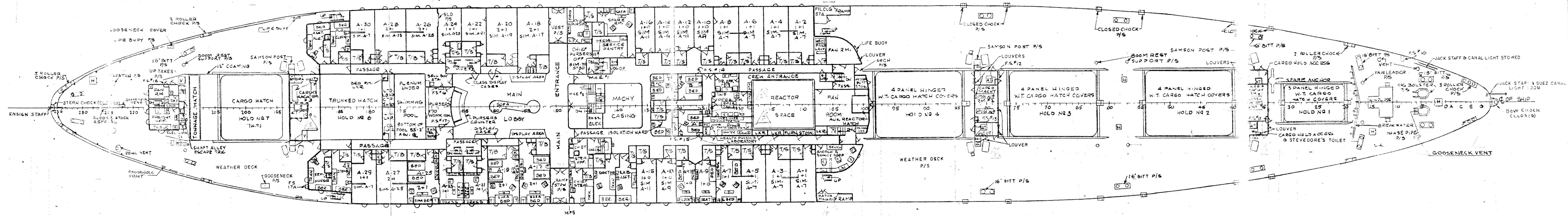

FR. 113 12

"A" DECK

SHEET NO. 7 OF 13

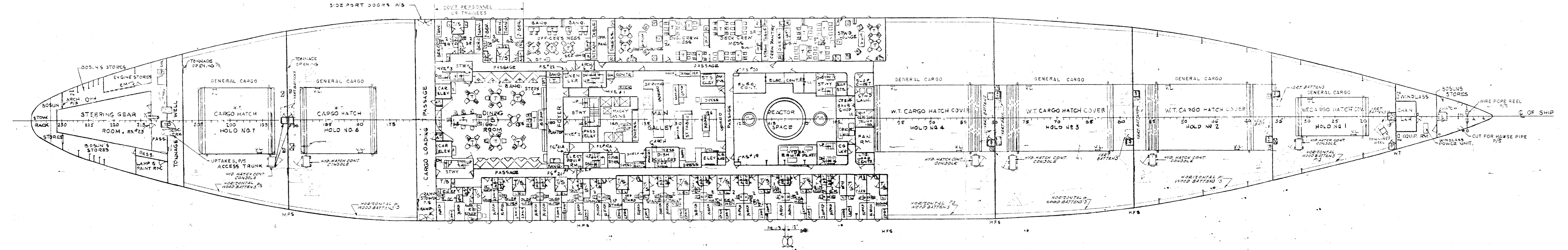

"B" DECK



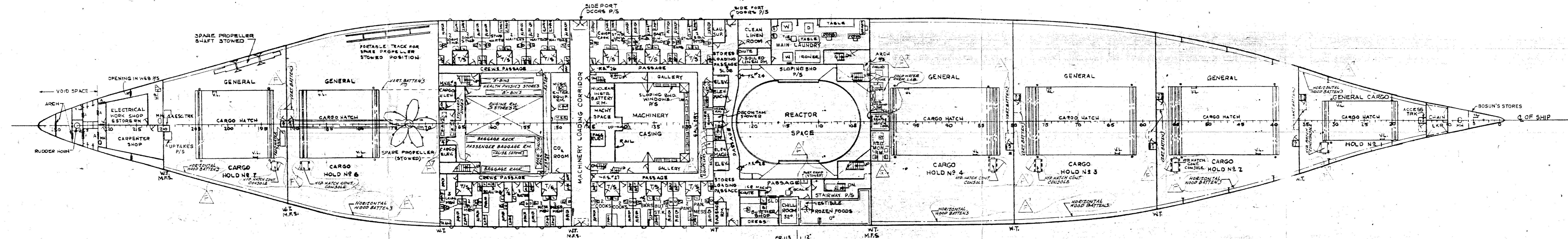

"C" DECK

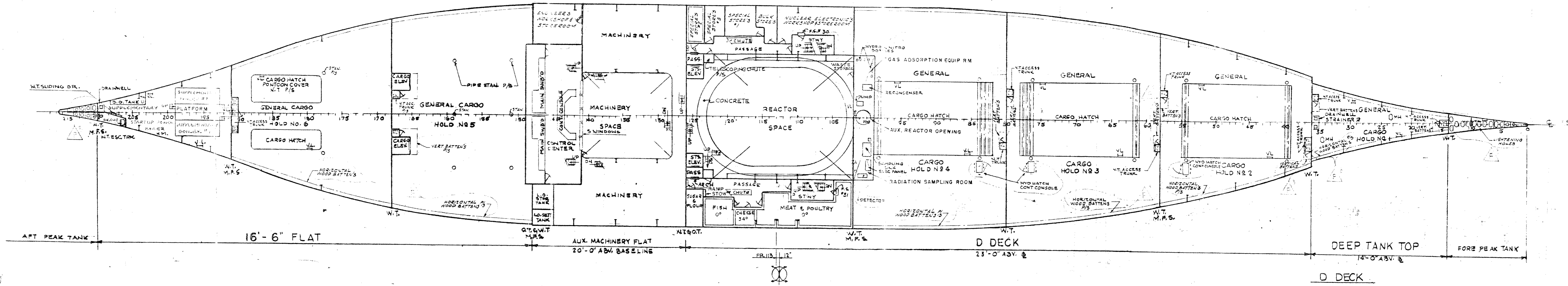

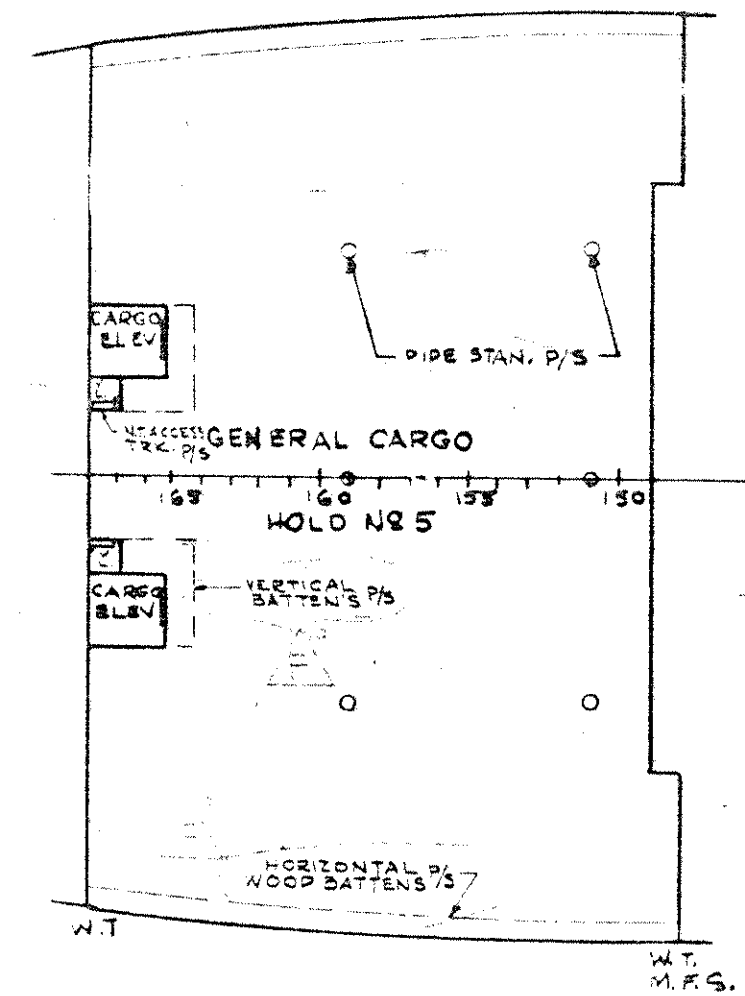

24'-6" FLAT

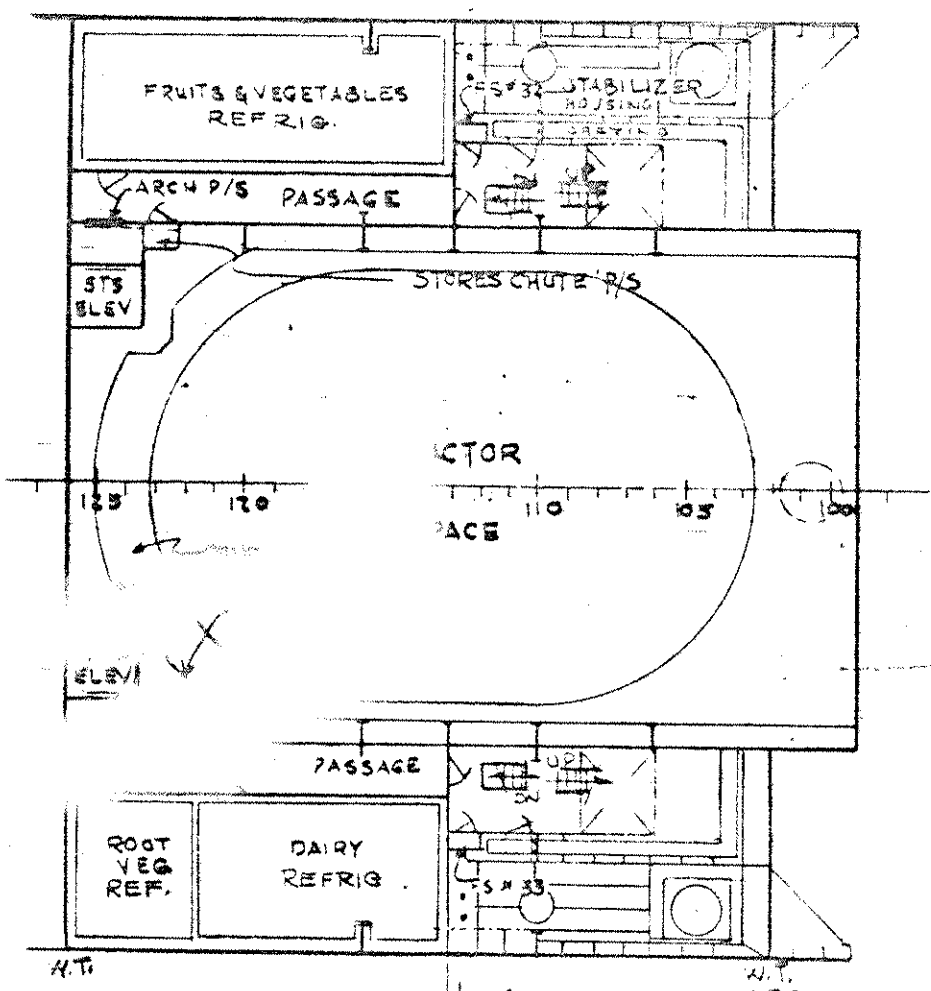

14'-0" FLAT

